

model no / **HIN Series** Ball Bearing Hinge



Hinge Grade: Grade 13

Finishes: SSS: Satin Stainless Steel  
PSS: Polished Stainless Steel

Material: Stainless Steel  
Grade: 304  
316 Up On Request

**Load Bearing Capacity up to 120kg**

- HIN1433: H 4" x W 3" x T 3MM
- HIN443 :H 4" x W 4" x T 3MM
- HIN454 :H 4.5" x W 4" x T 3.5MM
- HIN4545: H 4.5" x W 4.5" x T 3.5MM
- HIN643 :H 6" x W 4" x T 3MM

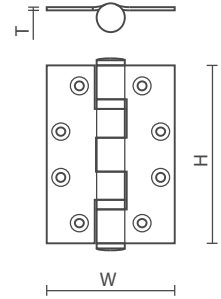

model no / **HINPH** Parliament Hinge



Finishes: PSS: Polished Stainless Steel  
PB: Polished Brass  
SSS: Satin Stainless Steel

Material: Stainless Steel  
Grade: 304  
316 Up On Request

- HINPH1 : 100 x W1: 75 x W2: 100
- HINPH2 : 100 x W1: 75 x W2: 125
- HINPH3 : 100 x W1: 100 x W2: 150

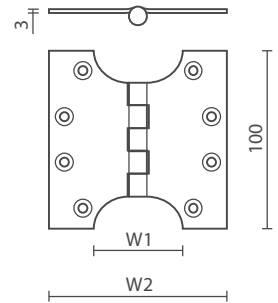

model no / **HINRS & HINFS series**

**Rising and Falling Hinge**



Finishes: SSS: Satin Stainless Steel  
PSS: Polished Stainless Steel

- HINRS1 : Left Hand Rising Butt Hinge, 102 x 76 x 3
- HINRS2 : Right Hand Rising Butt Hinge, 102 x 76 x 3
- HINFS1 : Left Hand Falling Butt Hinge, 102 x 76 x 3
- HINFS2 : Right Hand Falling Butt Hinge, 102 x 76 x 3

Material: Stainless Steel  
Grade: 304  
316 Up On Request

