

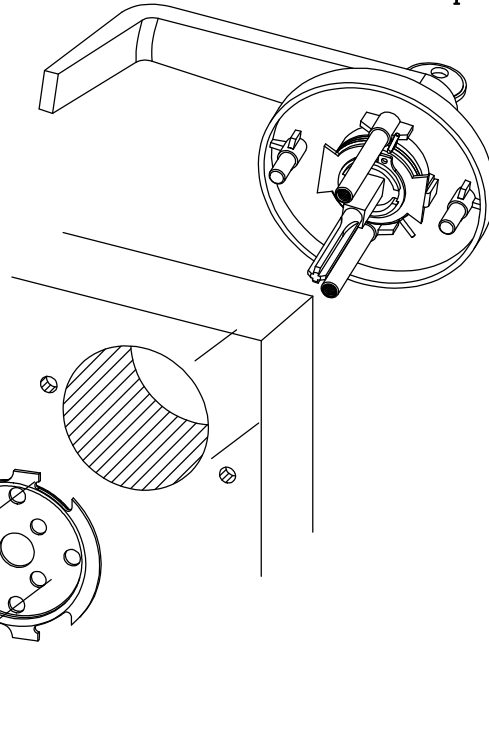

INSTALLATION INSTRUCTION

1. Sketch Map of Installation.



2. Drill hole.

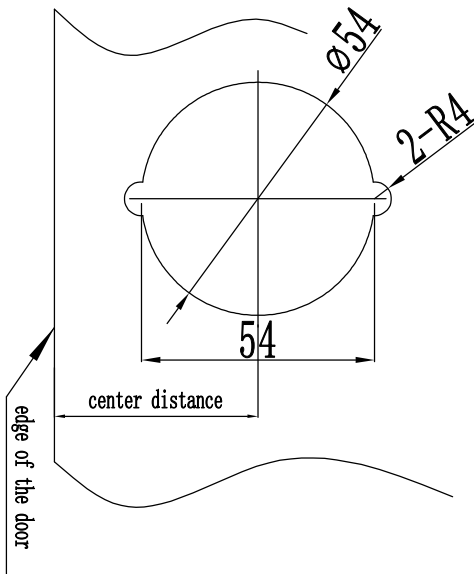

- (1) Keep the spindle horizontally before installation.
- (2) If insert the key and turn it counter-clockwise, the latch bolt will not retract by pressing the handle. And you can take out the key after turning it to original position.
- (3) If insert the key and turn it clockwise, the latch bolt will retract by pressing the handle. And you can take out the key after turning it to original position.
- (4) The spindle is contractable for different door thickness.

3. Size of central distance for single door.

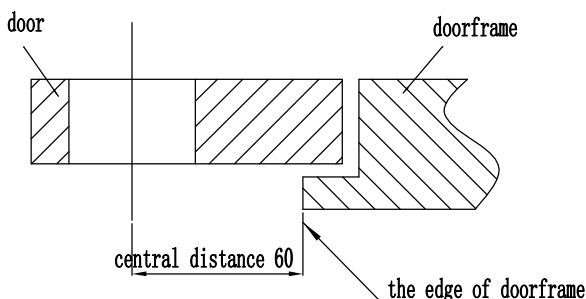

Size of central distance for double door.

